

## Type ASA34

Series of coils conforming to EN 175301-803-A, form A, insulation class F.

They can be mounted on the following valves: AX1, actuation: EG - KG.

For the connectors type A182... see page 2.210.30.



Voltage		Code	Item
24V	DC	034341	ASA3402400
24V	AC	034340	ASA3402450
110V	AC	034342	ASA3411050
240V	AC	034343	ASA3424050

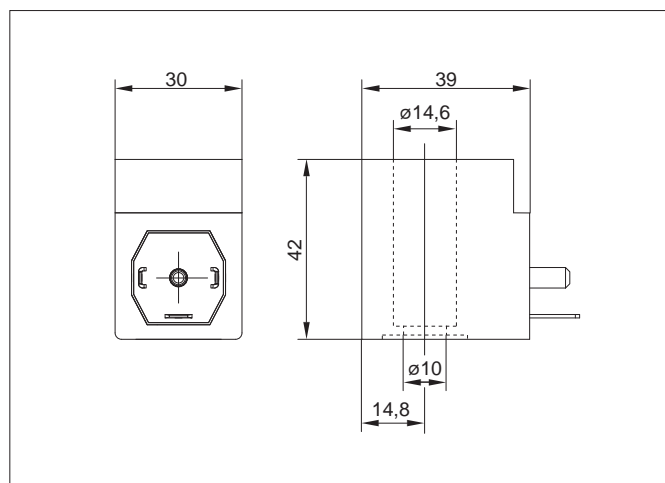

Technical data				
Voltage	24V DC	24V AC	110V AC	240V AC
Voltage tolerance	± 10%			
Frequency	-	50Hz	50Hz	50Hz
Electrical consumption	15,0W	19,3VA	17,6VA	17,6VA
Duty cycle	100% ED			
Class protection	IP 65 (according to EN60529)			
Temperature range	-20 °C ÷ + 50 °C*			
Insulation class	F (according to DIN VDE 60524)			
Protective class	I			

\*When using 24V AC the maximum ambient temperature must not exceed +40°C

